

Agenda Item 5

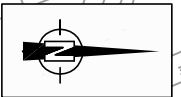
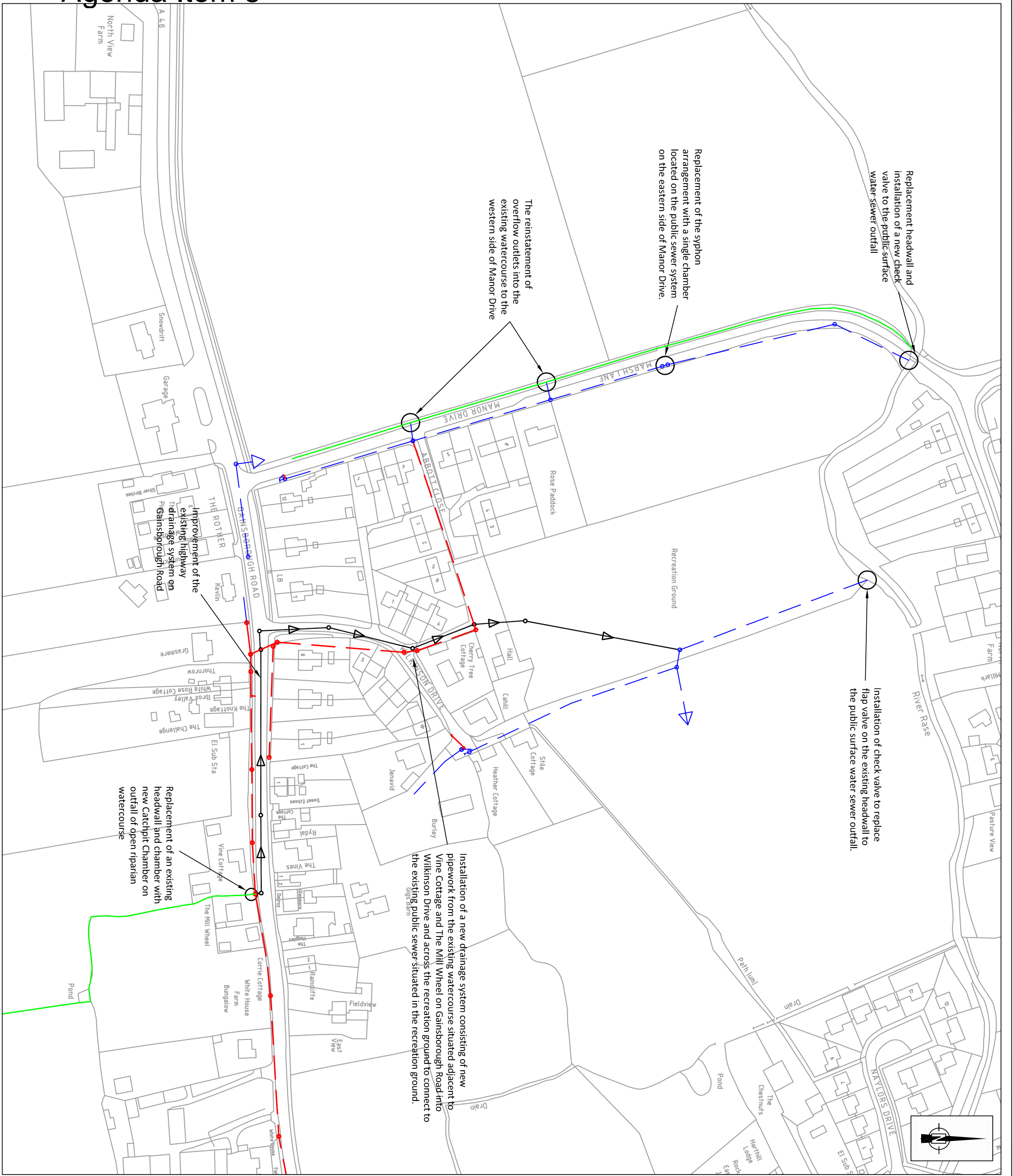

X-Rets & Blocks used in this Drawing
 x-osbase
 x - ScopeWorks

- Riparian Watercourse
- Existing Highway Drainage
- AWS Public Surface Water Sewer
- Proposed Highway Drainage

APPROVED FOR GENERAL ISSUE
 (NOT TO BE USED FOR PRICING OR CONSTRUCTION PURPOSES)
 FOR THIRD PARTY USE, THIS DRAWING SHALL BE DEEMED
 CURRENT ONLY AT THE DATE OF APPROVAL. PLEASE CHECK
 FOR AMENDMENTS BEFORE USE

Revision	Description	Drawn By	CAD Approval	Approved By	Date

1st Approval by: **PM** Date: **9/2/18**
 Drawn/Designed by: **LS** CAD Drawing Creation Date: **07/02/2018**
 Created By: **LS**

Scale: 1:2000
 (Do not scale from this drawing)

Lincolnshire
 COUNTY COUNCIL
 Highways Alliance
 TECHNICAL SERVICES PARTNERSHIP
 111, GRANBY STREET
 LINCOLN
 LEICESTERSHIRE
 LN1 1AB
 Customer Service Centre 01522 782070

Drawing Number: **0042** / 02 / 2502
 Scheme Reference: **100025370**
 Alternative Scheme Code: **MIDDLE RASEN**
 Parish: **MIDDLE RASEN**
 Structure No.: **SCN No.**
 Road No.: **A46**
 Site Ref:

**MIDDLE RASEN
 FLOOD ALLEVATION SCHEME
 OUTLINE SCOPE OF WORKS**

LINCOLNSHIRE COUNTY COUNCIL - Reproduced from Ordnance Survey material with the permission of Ordnance Survey on behalf of the Controller of Her Majesty's Stationery Office © Crown copyright. Unauthorised reproduction infringes Crown copyright and may lead to prosecution or civil proceedings. OS Licence 100025370
 ISP Error Issue 2016

This page is intentionally left blank